

'A'ala Park | Concept Sketch 1

Community Participatory Proof-of-Concept Design

COMMUNITY STEWARDSHIP

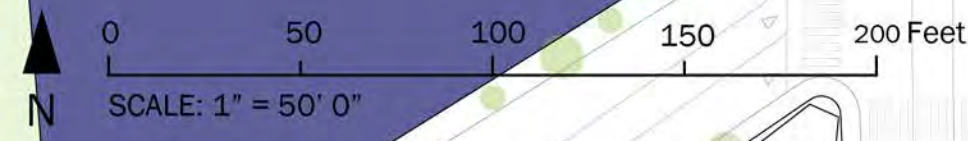
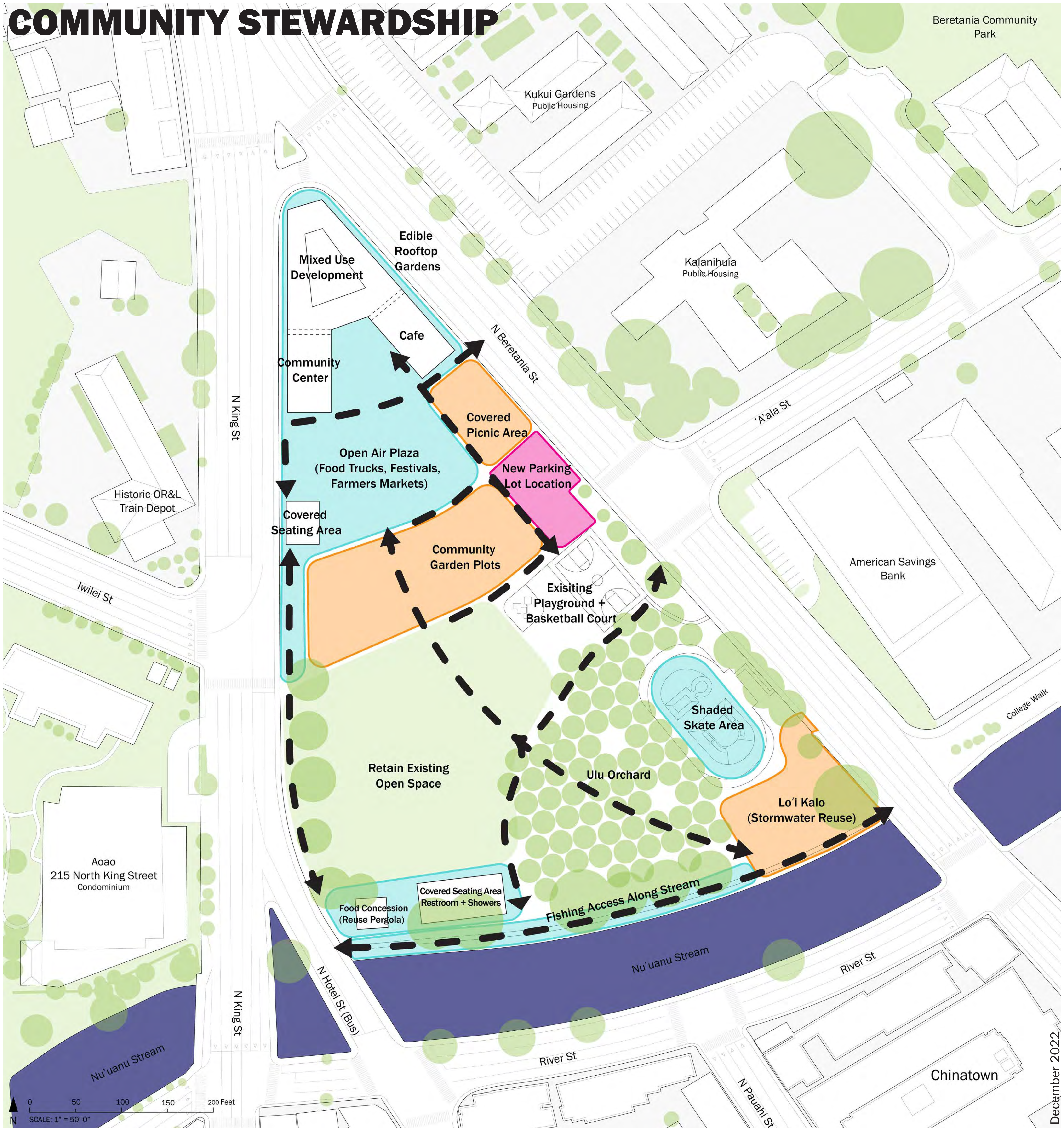

- Neighborhood Linkages
- Community Stewardship
- Recreation + Culture
- Proposed Circulation
- Proposed Buildings

This concept focuses on activating 'A'ala Park through programs that directly support the 'A'ala community, including a multi-story mixed use community center adjacent to a large plaza capable of hosting various events. Additional key programs and design features include an ulu orchard, community garden plots, and lo'i kalo to collectively recapture the cultural history of 'A'ala as a place of food production.



'A'ala Park | Community Stewardship

Example Projects Illustrating Design Ideas

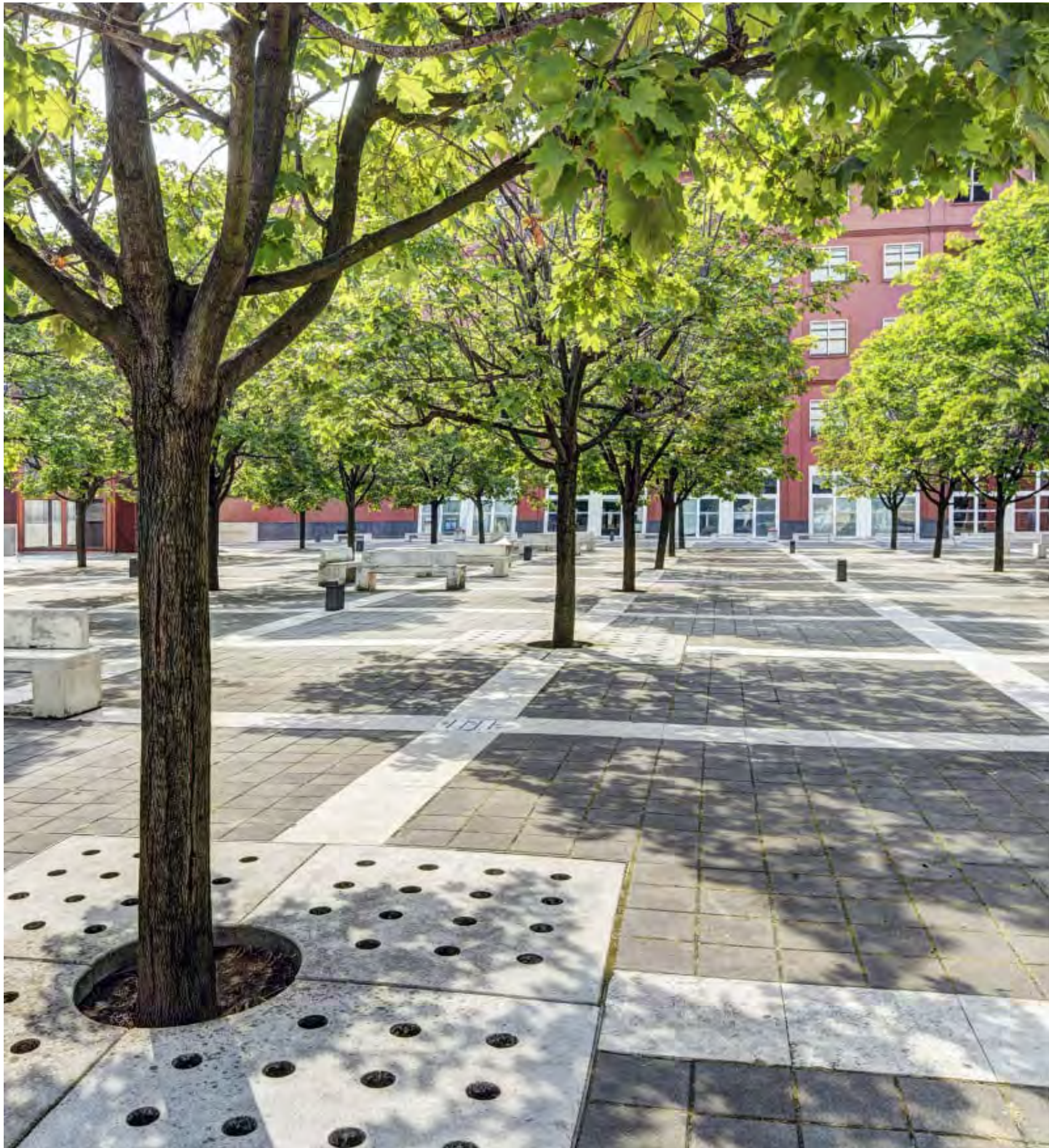

Trees planted in a grid formation define a space

Pia Bicocca in Milano, Italy
Image Source: shorturl.at/rwFRW



Community gardens educate and promote healthy lifestyles

Tremont Community Garden in New York City, New York



Imagining a future of fishing

Alakoko Fish Pond in Lihue, Hawaii

Image Source: The Trust For Public Land (<https://www.tpl.org/our-work#our-projects>), unless noted otherwise



Caring for kalo teaches Hawaiian cultural values

Lo'i Kalo at Waipa Kuleana in Kauai, Hawaii



Hygiene stations designed with open grating deter crime

Portland Loo in Vancouver, Canada
Image Source: shorturl.at/EMW7



Community Stewardship

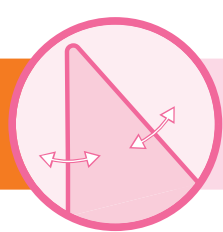

Neighborhood Linkages



Recreation + Culture

'A'ala Park | Concept Sketch 2

Community Participatory Proof-of-Concept Design

RECREATION + CULTURE

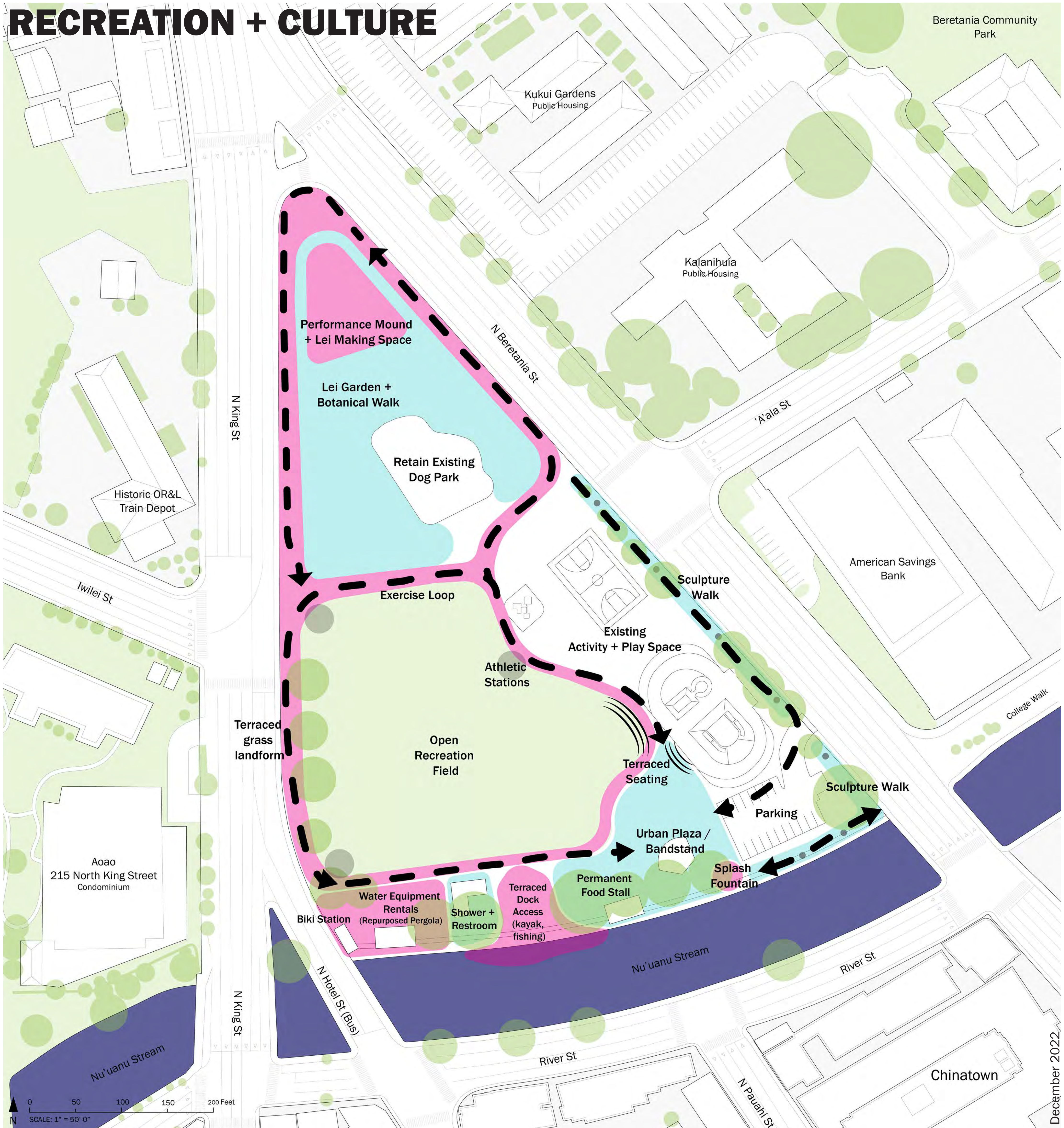

- Neighborhood Linkages
- Recreation + Culture
- Proposed Buildings
- Community Stewardship
- Proposed Circulation

This concept promotes access to land and water recreational opportunities by providing a walking loop with exercise stations and access to Nu'uaniu stream for kayak and canoe activities. A lei garden wrapping around the north end of the park provides a colorful and fragrant backdrop for the 'A'ala community and cultural events that take place on the performance mound.



'A'ala Park | Recreation + Culture

Example Projects Illustrating Design Ideas



Bandstands accommodate large outdoor festivals and special events

Kapiolani Bandstand in Honolulu, Hawaii
Image Source: shorturl.at/sBIMX



Outdoor exercise stations promote physical activity for a variety of fitness levels and abilities

Fitness Zones in Seattle, Washington

Image Source: The Trust For Public Land (<https://www.tpl.org/our-work#our-projects>), unless noted otherwise



Splash pads provide a fun play environment and desirable cooling amenity in warmer temperatures

Center Hill Park in Atlanta, Georgia



Open lawn areas provide visual balance and a flexible space for gathering

Rocky Graham Park in Marin County, California



Community Stewardship

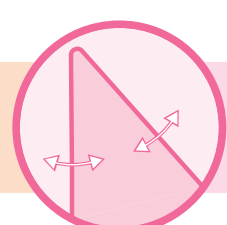

Neighborhood Linkages



Recreation + Culture

'A'ala Park | Recreation + Culture

Example Projects Illustrating Design Ideas



Open lawns invite gathering and social interaction

Washington Square Park in Los Angeles, California



Covered pavilions provide shade and seating opportunities

Madison Avenue Park and Community Garden in Los Angeles, California

Image Source: The Trust for Public Land (<https://www.tpl.org/our-work#our-projects>), unless noted otherwise



A stream bed is transformed to be an active gathering space

Cheonggyecheon Stream in Seoul, South Korea



Parks with a variety of recreational programs and activities invite use by all

Boeddeker Park and Clubhouse in San Francisco, California
Image Source: shorturl.at/DEGR4



Community Stewardship

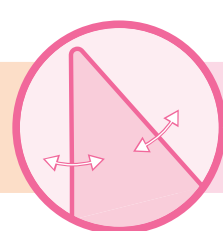

Neighborhood Linkages



Recreation + Culture

'A'ala Park | Concept Sketch 3

Community Participatory Proof-of-Concept Design

NEIGHBORHOOD LINKAGES

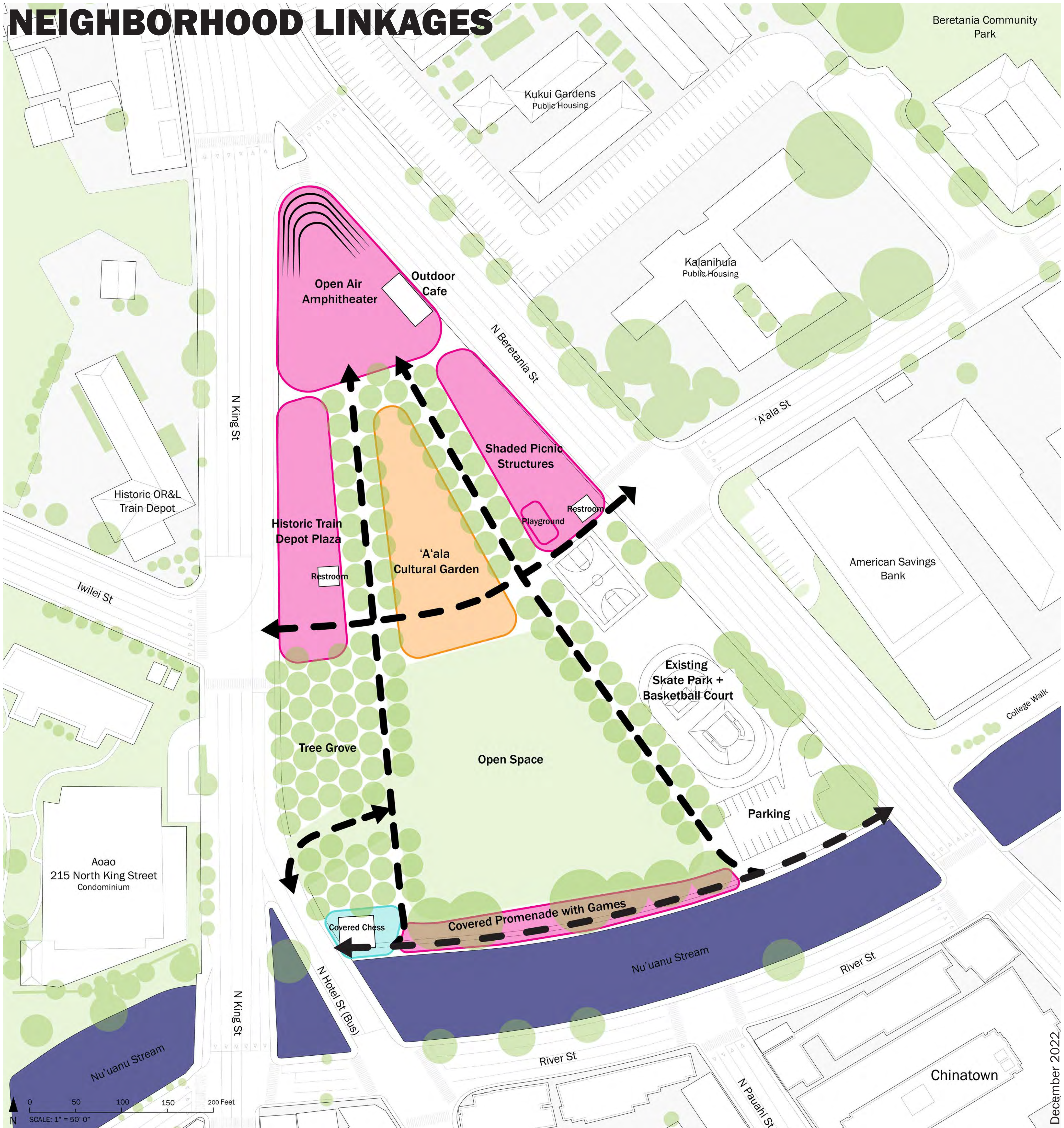

- Neighborhood Linkages
- Recreation + Culture
- Community Stewardship
- Proposed Circulation
- Proposed Buildings

This concept prioritizes reestablishing 'A'ala Park as a prominent place of gathering and connection to nearby businesses and residences. A new east-west pedestrian pathway defines clear access and is anchored by the 'A'ala Cultural Garden, a gathering space to celebrate the multicultural history of the 'A'ala neighborhood, and a large plaza along N King St to commemorate 'A'ala Park's connection to the historic OR&L Train depot.

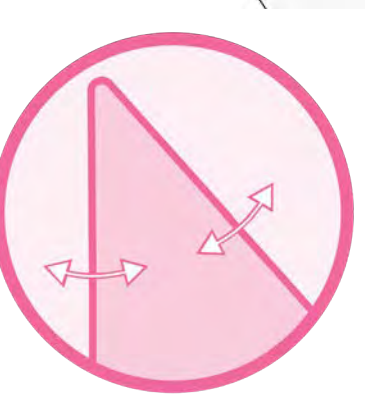

'A'ala Park | Neighborhood Linkages

Example Projects Illustrating Design Ideas



Mature trees create pleasant environments for people to gather and rest

Bryant Park in Manhattan, New York



Bringing the park alive with colors and outdoor games

PS 152/315K in Brooklyn, New York



Covered picnic areas provide shelter and gathering places

Middle Harbor Shoreline Park in Oakland, California
Image Source: shorturl.at/JOPT1



Open air amphitheaters are an invitation for outdoor events and performances

Historic Fourth Ward Park in Atlanta, Georgia

Image Source: The Trust For Public Land (<https://www.tpl.org/our-work#our-projects>), unless noted otherwise



Community Stewardship

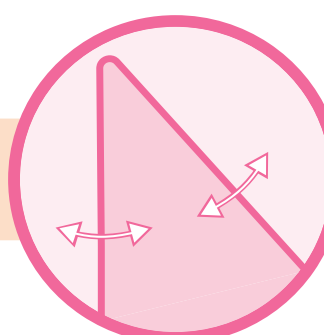

Neighborhood Linkages



Recreation + Culture

'A'ala Park | Share Your Ideas

Community Participatory Proof-of-Concept Design

Where does 'A'ala Park need the most improvement?

Place 1 dot in what you consider a problem area



'A'ala Park | Share Your Ideas

Community Participatory Proof-of-Concept Design

What additional improvement and park program ideas would you like to share with us?



Scan for digital survey

*Place
post-it
here*



Community Stewardship

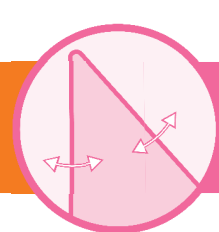

Neighborhood Linkages



Recreation + Culture